



Construction Work Zone Sign MUTCD Regulations

Are Your Signs **BIG ENOUGH?**

MUTCD 2009
CHAPTER 6C
Table 6C-2
p.555

30" x 30" WARNING SIGNS
are no longer permitted on most roads.

Are Your Signs **BRIGHT ENOUGH?**

All Ground Mounted Traffic Control Signs **MUST** be Type II Reflective or better.
All Roll-Up Signs *used at night* **MUST** be retro-reflective.

Fluorescent Orange
VIP

Orange
HIP

Are Your Signs **CORRECT?**

There are new signs in every section of the 2009 MUTCD, as well as, many signs that are no longer an option.

COMPLIANCE REQUIRED

as signs are being replaced or refurbished because they are damaged, missing, or no longer serviceable for any reason.

For more information, call customer service, visit our website: www.cpcsigns.com or the official MUTCD website: <http://mutcd.fhwa.dot.gov>

Reduced Speed Ahead Signs and many word signs have been replaced with symbols.

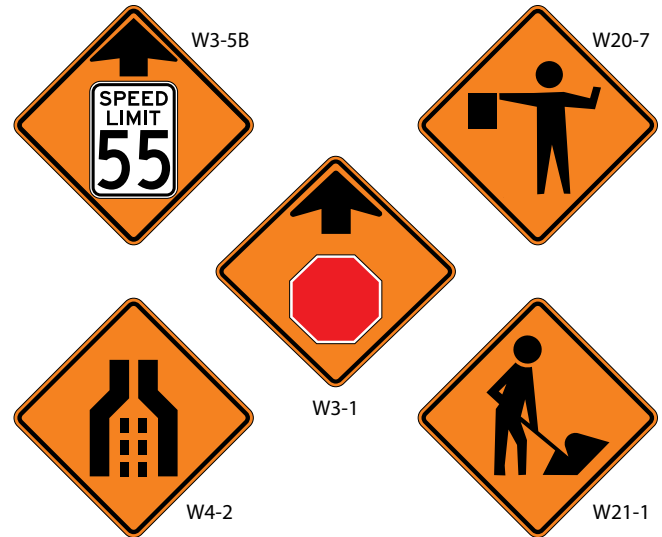

We recommend **3M** Fluorescent Orange VIP or Orange HIP for **Construction Work Zone Signs**

Are your sign supports crashworthy? *Choose a breakaway system or NCHRP-350 approved sign stand.*



Breakaway Systems for:

- ✓ U-Channel Posts
- ✓ Square Posts
- ✓ Round Posts

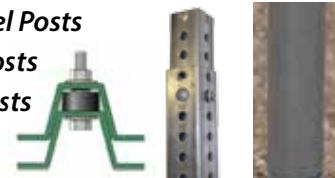

Our trained customer service team can assist you to ensure your sign supports meet MUTCD standards.

Visit our website for a full line of Sign Stands and Post Systems



VOICE: 1-800-367-1492 • FAX: 1-800-206-3444
sales@cpcsigns.com • www.cpcsigns.com